

# Assembly Instructions

## Cantilever Shelving – Free-Standing

1. Bolt horizontal cantilever cross braces to uprights.

**Do Not Tighten Bolts.**

- Horizontal cross braces (top and bottom) attach to the back side of the uprights, install them over the welded horizontal strap.
- The channel legs face forward, bolt heads are on the back side of cross brace.

Nut and washer install on the front side.

**(See Figure 1)**

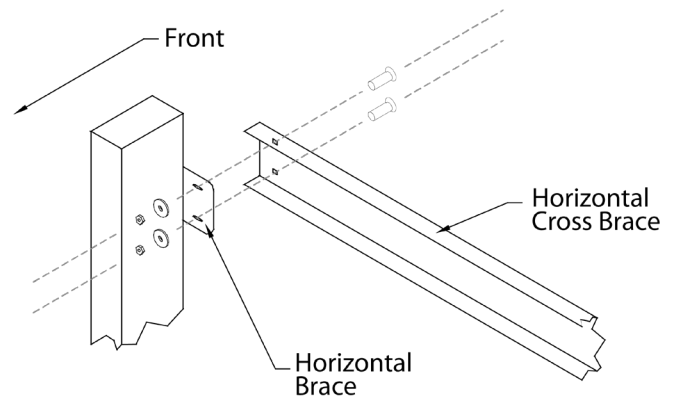
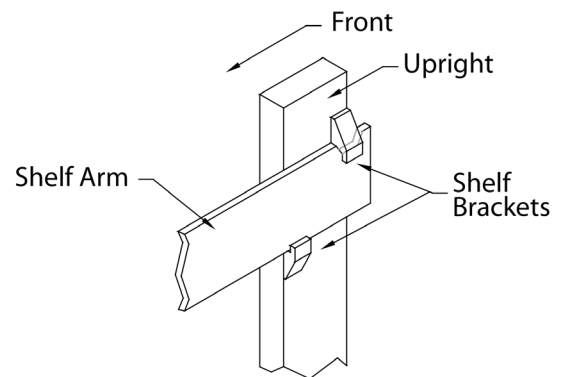

**Figure 1**

2. Position **one** shelf at the **top and bottom** of each shelving section. *(One in the highest and one in the lowest position.)*

**(See Figure 2)**

3. Tighten bolts
4. **Use adjustable foot on each upright to make upright level — Straight up and down.**
5. Adjust shelves to your satisfaction.



**Figure 2**



**Failure to install shelving correctly can lead to collapsing of unit and/or result in injury.**

**Assembly Video**

