

## Wall Shelves -- Slanted

The slanted design of this wall shelf prevents water from pooling, therefore dries faster. The t-bar design also allows water to drain through shelf, keeping things dry.

### Material:

- **Frame** is constructed of 1 1/4" x 1 1/2" x .070 wall extruded aluminum tube.
- **Shelves** are constructed of 1 1/4" x 2 1/4" x .100 wall extruded aluminum T-Bar with 1 3/4" spacing.
- **Lip** on three sides is constructed of 1/8" x 1 1/2" strap.
- **Mounting angle** is constructed of 1 1/2" x 1 1/2" x .188" wall angle.

### Guarantee:

- **Lifetime Guarantee** against rust and corrosion.
- **Five-Year Guarantee** against workmanship and material defects.



Model No.	Size D-L	Wt. Cap.	Ship Lbs.
<b>Slanted T-Bar Wall Shelves</b>			
97102	21" x 48"	600	26



Slanted T-Bar Wall Shelf

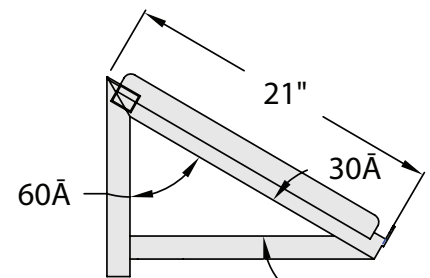
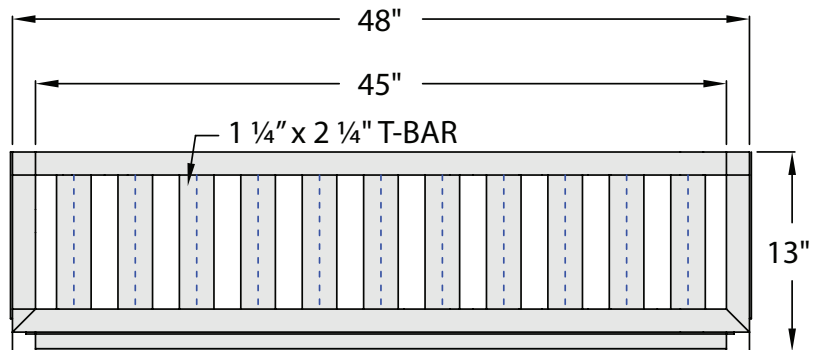

#97102

This information is for general sales and engineering use only. New Age Industrial reserves the right to modify or make changes at any time without notice to materials and specifications.

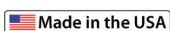

Distributed by: